

FIRDOUS RESIDENCY

 **mark** Properties

4 & 5 ROOMS
LUXURIOUS APARTMENTS
LOCATED IN THE HEART OF GULISTAN-E-JAUHAR



Firdous Residency **Amenities**

Well Planned and Designed Construction to createvie Concept of Living
Elegance close to Luxury



2 & 3 BEDROOMS

Interactively procrastinate
high-payoff content without
backward compatible data.



AMPLE CAR PARKING

Credibly innovate granular
internal or "organic" sources
whereas high standards in
web-readiness.



STANDARD TILE FLOORING

Interactively procrastinate
high-payoff content without
backward-compatible data.



ALTERNATE POWER AVAILABILITY

Credibly innovate granular
internal or "organic" sources
whereas high standards in



ROAD ON 3 SIDES

Interactively procrastinate
high-payoff content without
backward-compatible data.



FIVE UNIQUE DESIGN APARTMENTS

Credibly innovate granular internal
or "organic" sources whereas high
standards in web-readiness.



PASSENGER & CARGO LIFTS

Interactively procrastinate
high-payoff content without
backward-compatible data.



FIRE FIGHTING PROVISIONS

Credibly innovate granular
internal or "organic" sources
whereas high standards in

Executive

Apartment Categories

4 Rooms Luxurious Apartment

5 Rooms Luxurious Apartment

Layout Plan

5 Rooms Apartment "A"

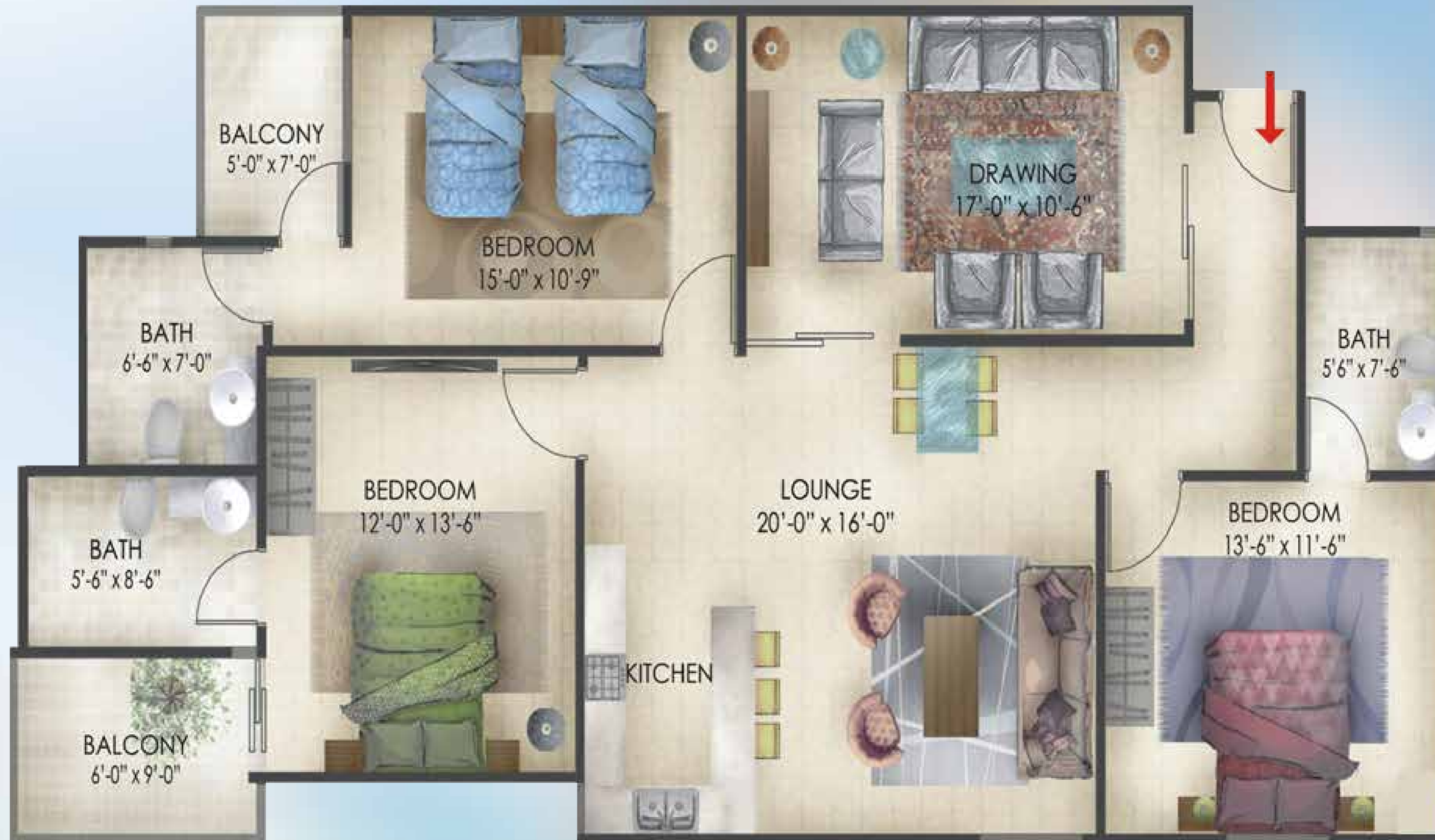

Description	Price Plan
On Booking	4,800,000
12 Monthly Installments	$\frac{360,000 \times 12}{4,320,000}$
02 Half Yearly Installments	$\frac{1,440,000 \times 2}{2,880,000}$
Before Possession	1,200,000
TOTAL COST	13,200,000

EXTRA CHARGES

ROAD FACING	200,000
WEST OPEN	200,000
CORNER	200,000

IMPORTANT NOTE

1. Electric/ Gas/ Water Connection charges including meter deposit and documentation/ registration charges. Fees for sub-lease, loan, misc. charges will be payable extra by the allottee/buyer on demand.
2. All extra charges will be payable within 120 days from the date of booking.
3. All the installment must be deposited before the 10th of every month as per terms and conditions.
4. All discounts are subject to regular payment as per schedule.
5. Special discount 10% shall be allowed against full cash payment at the time of booking/ allocation. Read, Understood and Accepted.

Layout Plan

5 Rooms Apartment "B"



Description	Price Plan
On Booking	4,500,00 0
12 Monthly Installments	$\frac{330000 \times 12}{3,960,000}$
02 Half Yearly Installments	$\frac{1,320,000 \times 2}{2,640,000}$
Before Possession	1,100,000
TOTAL COST	12,200,000

EXTRA CHARGES	
ROAD FACING	200,000
WEST OPEN	200,000
CORNER	200,000

IMPORTANT NOTE

1. Electric/ Gas/ Water Connection charges including meter deposit and documentation/ registration charges. Fees for sub-lease, loan, misc. charges will be payable extra by the allottee/buyer on demand.
2. All extra charges will be payable within 120 days from the date of booking.
3. All the installment must be deposited before the 10th of every month as per terms and conditions.
4. All discounts are subject to regular payment as per schedule.
5. Special discount 10% shall be allowed against full cash payment at the time of booking/ allocation. Read, Understood and Accepted.

Layout Plan

5 Rooms Apartment "C"

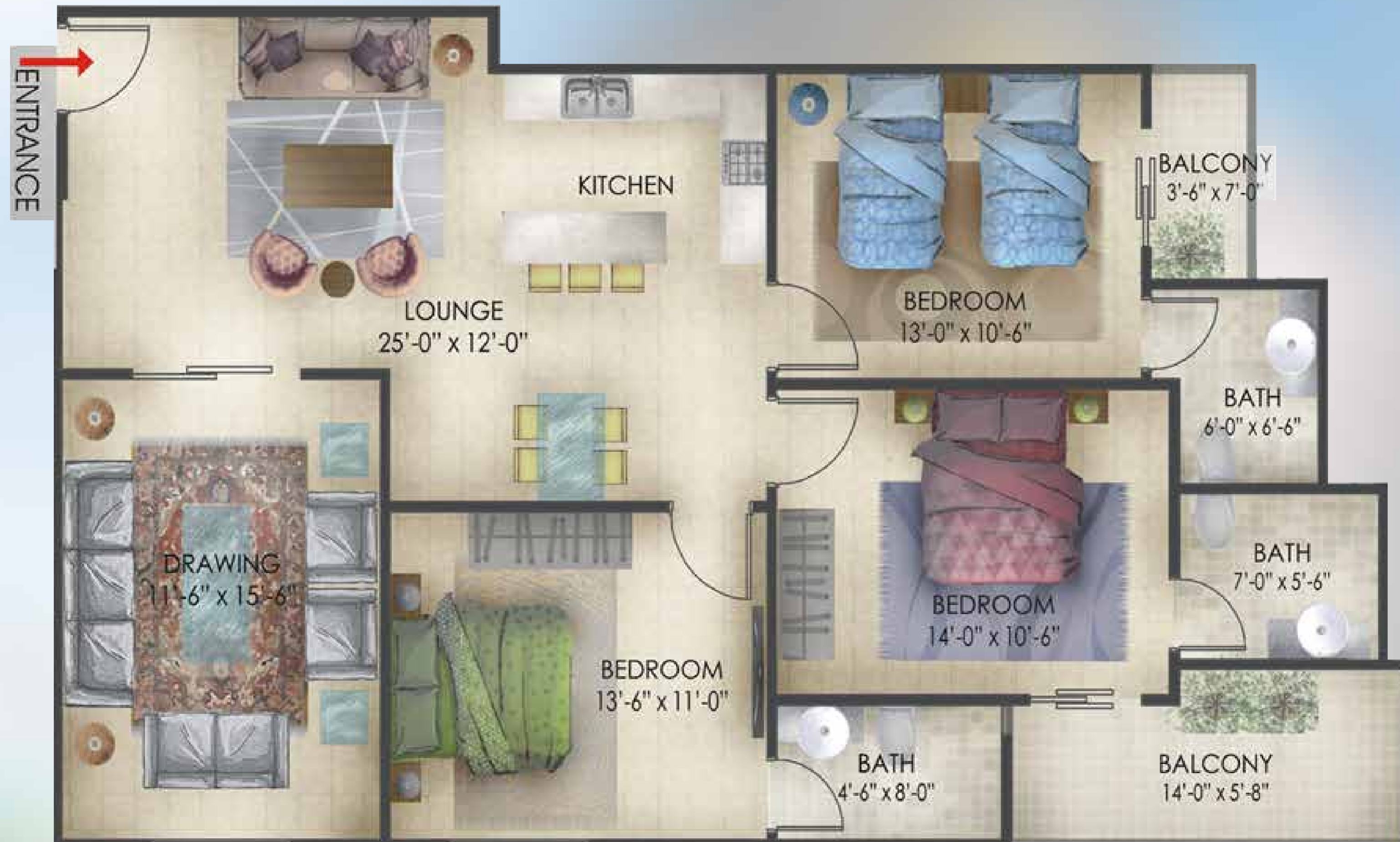

Description	Price Plan
On Booking	3,700,000
12 Monthly Installments	$\frac{300,000 \times 12}{3,600,000}$
02 Half Yearly Installments	$\frac{1,200,000 \times 2}{2,400,000}$
Before Possession	1,000,000
TOTAL COST	10,700,000

EXTRA CHARGES	
ROAD FACING	200,000
CORNER	200,000

IMPORTANT NOTE

1. Electric/ Gas/ Water Connection charges including meter deposit and documentation/ registration charges. Fees for sub-lease, loan, misc. charges will be payable extra by the allottee/buyer on demand.
2. All extra charges will be payable within 120 days from the date of booking.
3. All the installment must be deposited before the 10th of every month as per terms and conditions.
4. All discounts are subject to regular payment as per schedule.
5. Special discount 10% shall be allowed against full cash payment at the time of booking/ allocation. Read, Understood and Accepted.

Layout Plan

4 Rooms Apartment "D"

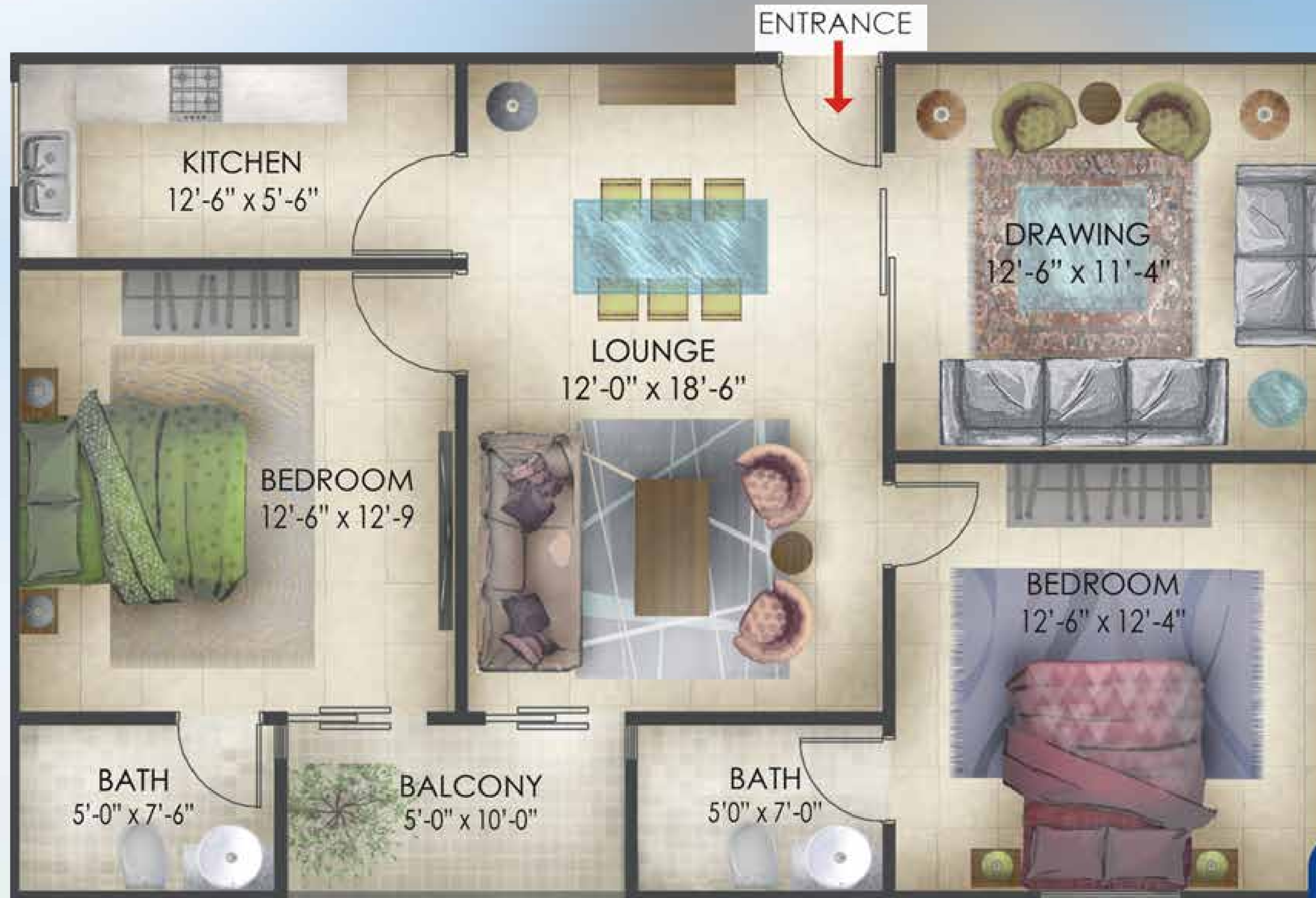

Payment Plan

4 Rooms Apartment “D”

Description	Price Plan
On Booking	3,200,000
12 Monthly Installments	$\frac{270,000 \times 12}{3,240,000}$
02 Half Yearly Installments	$\frac{1,080,000 \times 2}{2,160,000}$
Before Possession	900,000
TOTAL COST	9,500,000

EXTRA CHARGES

ROAD FACING 200,000

IMPORTANT NOTE

1. Electric/ Gas/ Water Connection charges including meter deposit and documentation/ registration charges. Fees for sub-lease, loan, misc. charges will be payable extra by the allottee/buyer on demand.
2. All extra charges will be payable within 120 days from the date of booking.
3. All the installment must be deposited before the 10th of every month as per terms and conditions.
4. All discounts are subject to regular payment as per schedule.
5. Special discount 10% shall be allowed against full cash payment at the time of booking/ allocation. Read, Understood and Accepted.

Layout Plan

4 Rooms Apartment "E"

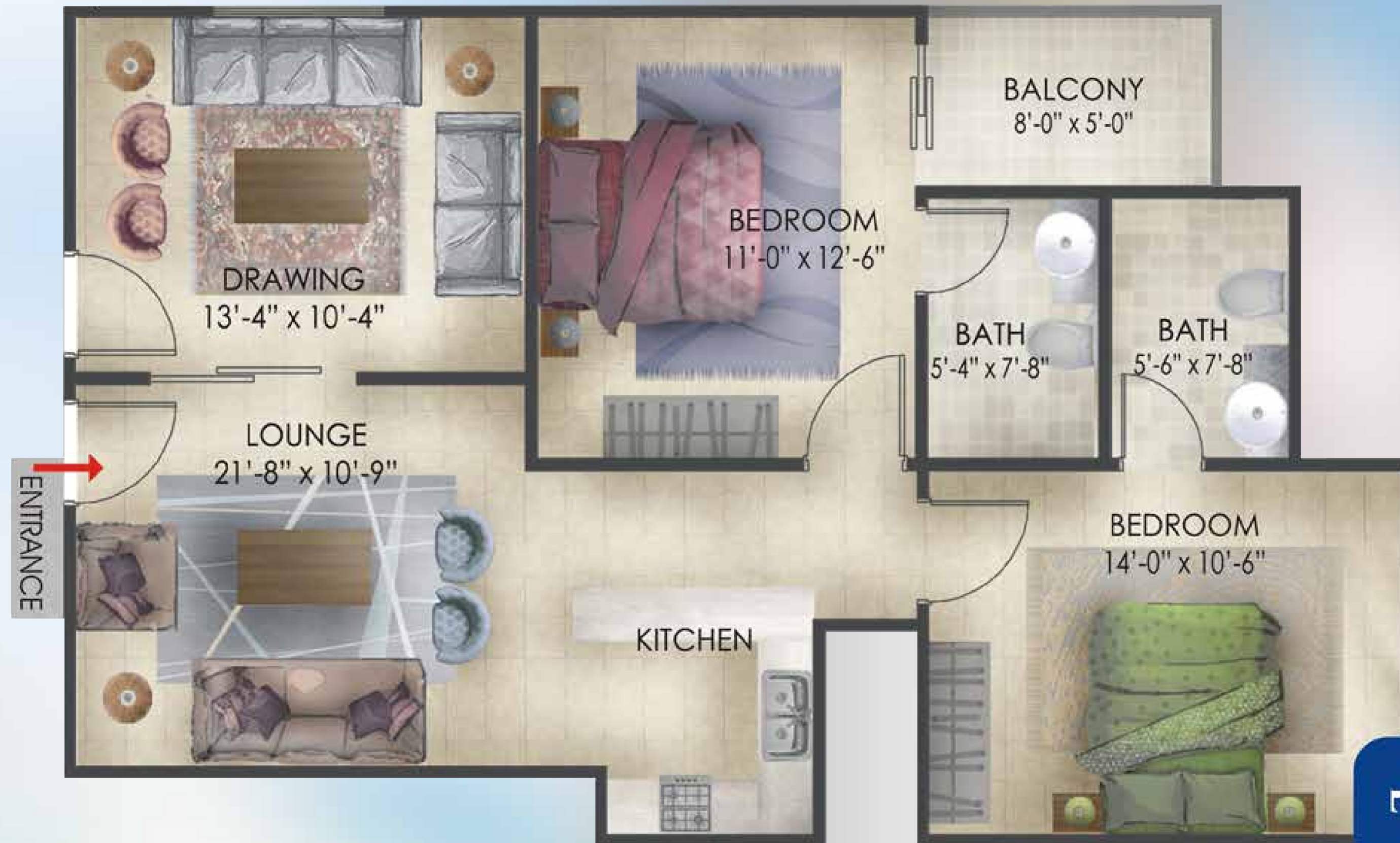

Payment Plan

4 Rooms Apartment “E”

Description	Price Plan
On Booking	3,200,000
12 Monthly Installments	$\frac{240,000 \times 12}{2,880,000}$
02 Half Yearly Installments	$\frac{960,000 \times 2}{1,920,000}$
Before Possession	800000
TOTAL COST	8,500,000

EXTRA CHARGES

CORNER

200,000

IMPORTANT NOTE

1. Electric/ Gas/ Water Connection charges including meter deposit and documentation/ registration charges. Fees for sub-lease, loan, misc. charges will be payable extra by the allottee/buyer on demand.
2. All extra charges will be payable within 120 days from the date of booking.
3. All the installment must be deposited before the 10th of every month as per terms and conditions.
4. All discounts are subject to regular payment as per schedule.
5. Special discount 10% shall be allowed against full cash payment at the time of booking/ allocation. Read, Understood and Accepted.

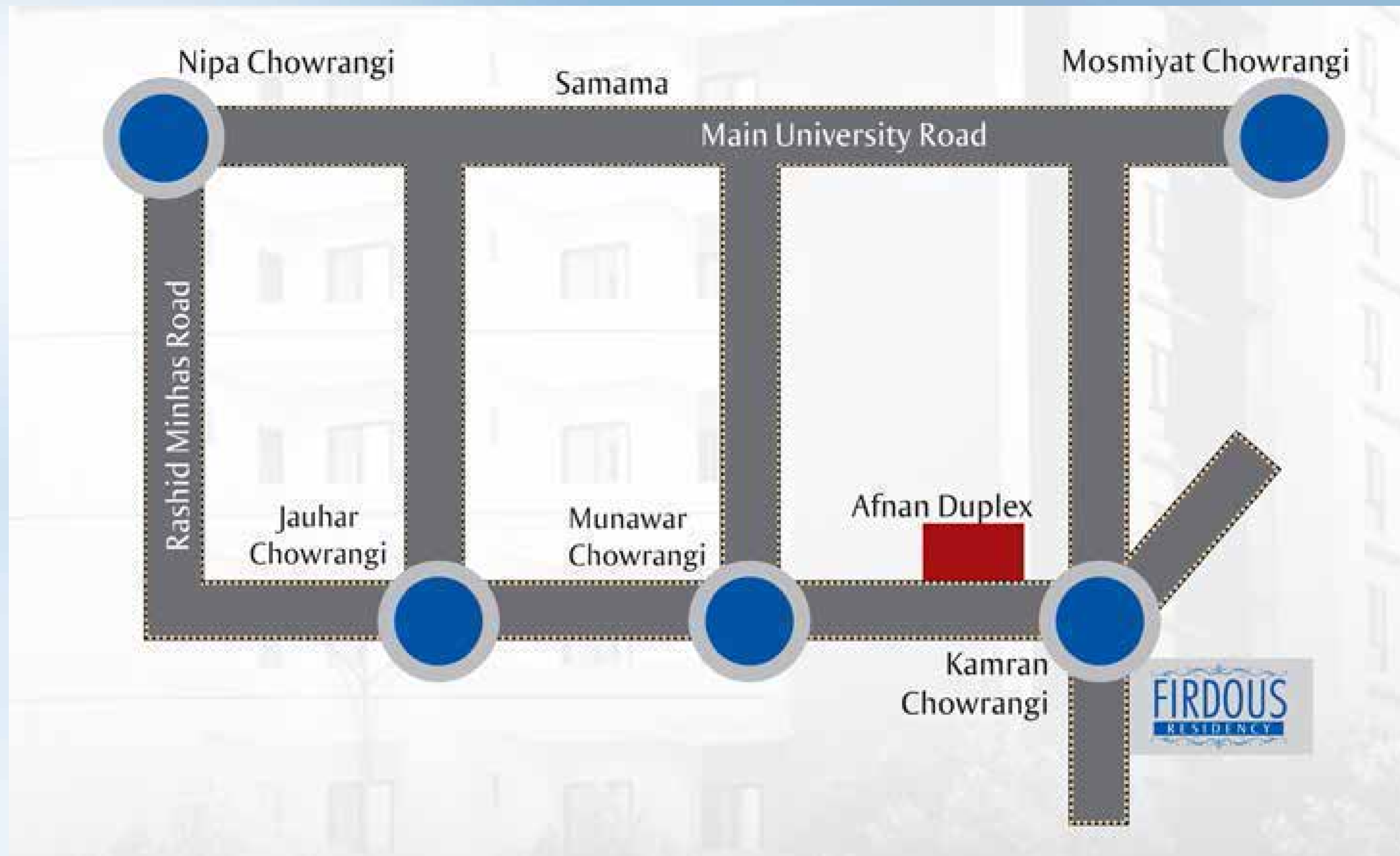

For visit call us at
0331-2496124